

Leading lights

LEN1000 • HIGH-DEFINITION SECTORISED LEADING LIGHT



The LEN1000 high definition sectorised leading light and great , has been especially developed to be used in port accessing leading channels and similar for day and night operation. The light generates a high definition sectorised unidirectional beam of light which an horizontal divergence of 3.5° using maritime signalisation lamps. It can be used in leading channels to give a complete signal from a single station.

The lantern beam of light is divided into colour sectors according to IALA Recommendations. The great accuracy in every sector definition $< 0.05^\circ$, allows users exactly determine its location in relation to the channel axis.

Features

- Normal luminous range in daylight up to 6 n.m. ($T = 0.74$)
- Nominal luminous range at night up to 25 n.m. ($T = 0.74$)
- Heavy-duty light with lantern, hermetically sealed.
- Materials resistant to marine environment.
- Aspheric + spherical condenser.
- 6 position automatic lampchanger.
- DES33 solid-state flasher of low internal consumption.
- Voltage regulation to the lamp to any value between 6.2 and 24 V.
- Automatic intensity reduction at night using lamp voltage reduction and insertion of grey filter.
- All hardware and hinges from stainless steel.
- Assembly of internal components (Lens, electronics...) on the base plate.
- Rifle-type peepholes.
- Easy levelling and adjusting in the base.
- Visor to minimise reflections.

Options

- Red, green and yellow filters.
- AC operation.
- GSM/GPRS Modem.
- SYNC-GPS synchroniser.
- Remote control and monitoring.
- Oscillating boundary.

Range of lamps

- Standard lamps are halogen prefocused lamps, single filament.

Technical specifications

- Power supply from 12 to 35 V.
- Aspheric+spherical condenser glass lens.
- Accuracy: 0.05° ($3'$ of arc).
- Horizontal divergence beam of light 3.5° .
- Maximal Vertical divergence is equal to the total horizontal divergence.
- Flashing, isophase or occulting flash characters. Max. RLP 60%
- Individual sectors custom-made for each light.
- Fixing: 4 nos. off M10 bolts.
- Watertightness degree IP-66.
- Electromagnetic Compatibility CE
- Net weight: 60 kg
- Dados para transporte: $2,8 \times 0,6 \times 0,8 \text{ m}$ ($1,344 \text{ m}^3$) 200 kg

LEN1000	Fixed intensities (Cd)		
Horizontal divergence	3.5°		
Colour	White	Red	Green
Lamps 24 V / 250 W	750.000	220.000	235.000
Lamps 12 V / 100 W	302.000	82.000	73.000

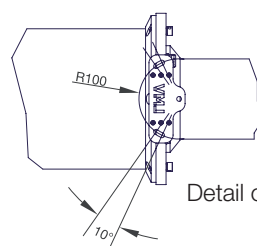
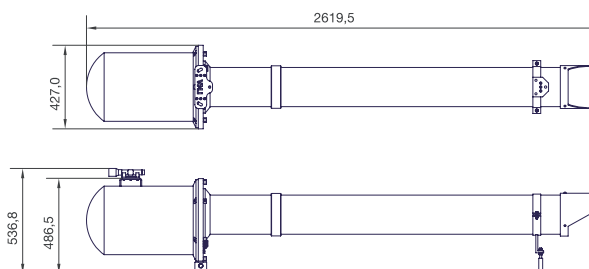
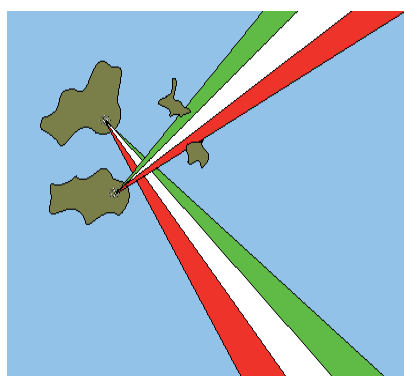
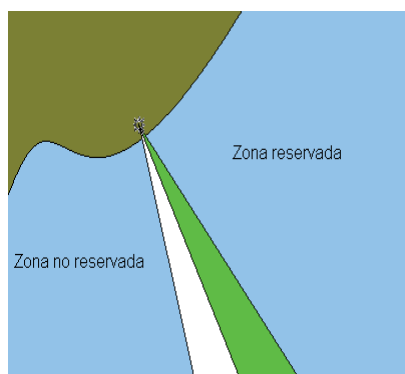

Detail of the direction system

